



SEFW
TALL OAKS CNI

Creating Neighborhoods of Choice

Community Meeting Draft Review and Feedback

THURSDAY, SEPTEMBER 12TH, 2024



FORT WAYNE housing authority



Introduction

HUD's Choice Core Goals

HOUSING – Replace distressed public and assisted housing with high-quality mixed-income housing that is well-managed and responsive to the needs of the surrounding neighborhood

PEOPLE – Improve outcomes of households living in the target housing related to employment and income, health, and children's education; and

NEIGHBORHOODS – Create the conditions necessary for public and private reinvestment in distressed neighborhoods to offer the kinds of amenities and assets, including safety, good schools, and commercial activity that are important to families' choices about their community





SEFW – TALL OAKS CHOICE NEIGHBORHOODS

Types of CNI Grant Awards

Planning Grants: two-year grants that support the development of comprehensive neighborhood revitalization plans which focus on directing resources to address the three core goals: Housing, People, and Neighborhoods.

Typical Planning Grants Awards: \$500,000

SEFW CNI Award

In December 2022, the Fort Wayne Housing Authority and the City of Fort Wayne were awarded the coveted Choice Neighborhoods Planning Grant

The Planning Grant will engage the SEFW CNI community over 24 months to formulate a Transformation Plan.



SEFW – TALL OAKS CHOICE NEIGHBORHOODS

SEFW Neighborhood CNI Boundary

- North:** E Pontiac St
- West:** Lafayette St (US Hwy 27)
- East:** Wayne Trce/Hessen Cassel Rd & S Anthony Blvd
- South:** E Tillman Rd & McKinnie Ave

★ Tall Oaks Apartments Location

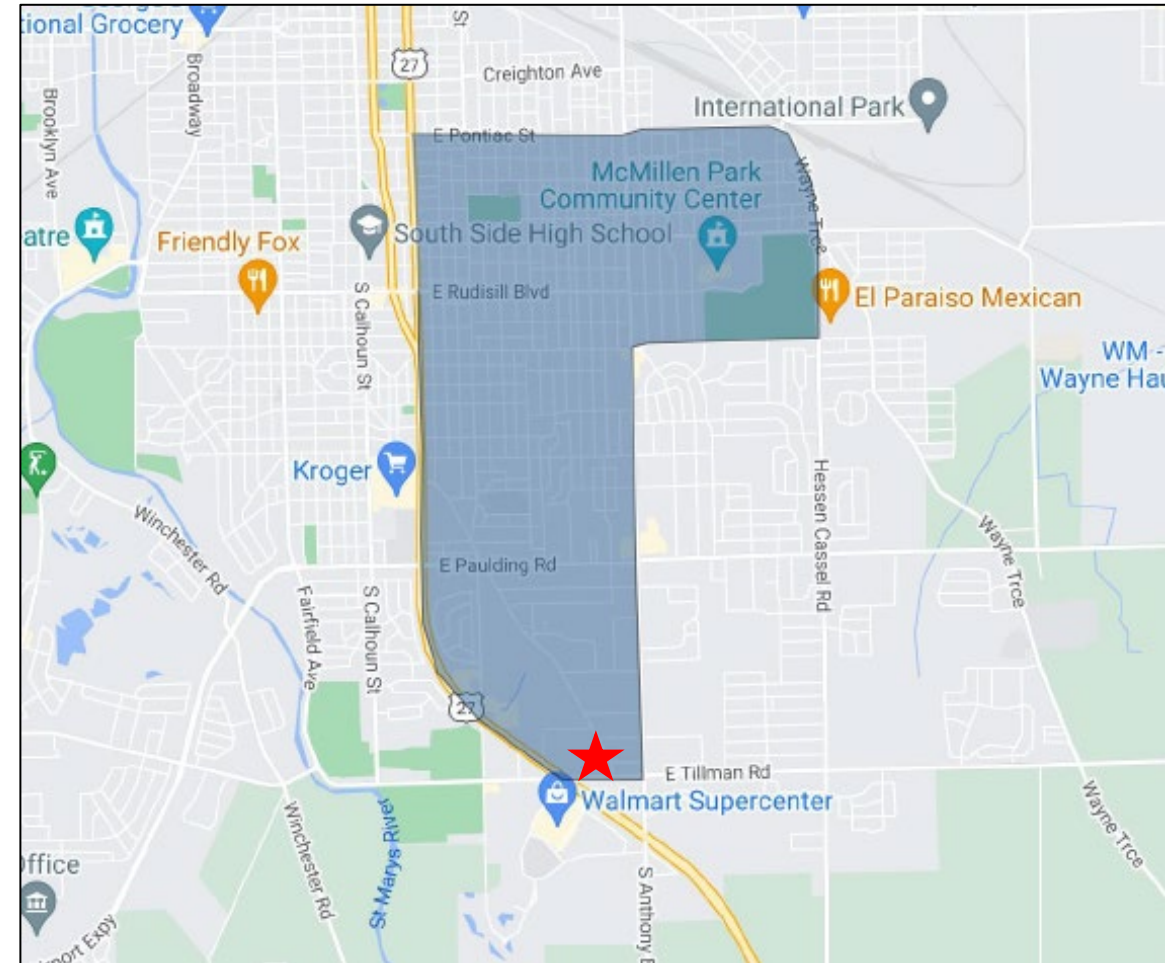

HUD Distressed Property: Tall Oaks Apartments

- Built in 1970
- Seven-story elevator apartment building
- 105 Dwelling Units of Public Housing
 - One bedroom
 - Two-bedrooms



New additional parking
- Completed in 2022





Transformation Plan Goals and Strategies

Data Sources and Outcomes

- Community Survey
- Business Survey
- Topic Survey
- Resident Assessments
- Market Study
- Focus Groups
- Committee Members



- Vision
- Themes
- Goals
- Strategies



SEFW – TALL OAKS CHOICE NEIGHBORHOODS

Feedback QR

As we go through the Goals of the Transformation plan, feel free to provide your feedback.

Scan the QR to submit your feedback.





SEFW – TALL OAKS CHOICE NEIGHBORHOODS

Transformation Plan Components & Themes

**Housing
Plan**



*Accessible and
Affordable Quality
Housing*



SEFW – TALL OAKS CHOICE NEIGHBORHOODS

Housing Plan

GOALS

Provide more diverse housing options

Homeownership program awareness



Transformation Plan Components & Themes

**People
Plan**



*Economic Growth and
Development*

*Community Health and
Wellness*

Education and Youth



SEFW – TALL OAKS CHOICE NEIGHBORHOODS

People Plan

GOALS

Improve Access to Quality Education for All Ages

Expand Adult Education and Skill Development Opportunities

Provide Positive and Engaging Opportunities for Youth

Foster Youth Employment and Career Readiness

Enhance Access to Health and Wellness Services

Improve Environmental Health and Safety

Increase Employment Opportunities for Residents

Support Entrepreneurship and Small Business Development



Transformation Plan Components & Themes

**Neighborhood
Plan**



Safety and Security

*Environment and
Sustainability*

*Transportation and
Connectivity*



SEFW – TALL OAKS CHOICE NEIGHBORHOODS

Neighborhood Plan

GOALS

Improving policing and security efforts

Improve access to ability-friendly routes

Access to alternative options for mobility and connectivity

Encourage environmentally conscious and sustainable practices





Early Action Activities



SEFW – TALL OAKS CHOICE NEIGHBORHOODS

Early Action Activity

Refers to limited, physical neighborhood improvements undertaken during the planning process.

These activities should support the planning process through:

- Engaging the community
- Fostering social cohesion
- Reinforce the planning process

Activities **must**:

- Be responsive to neighborhood needs
- Used for physical community development or
- Economic development that enhances and accelerates the transformation of the neighborhood.



SEFW – TALL OAKS CHOICE NEIGHBORHOODS

Early Action Activity Cont.

Early Action Activities **cannot** be used for:

- Non-physical uses, such as supportive services, administrative costs, marketing
- Basic infrastructure or as a substitute for basic municipal services; or
- Redevelopment of public or HUD-assisted housing targeted by application, including acquisition, relocation, demolition and remediation, rehabilitation, or construction of the targeted housing



SEFW – TALL OAKS CHOICE NEIGHBORHOODS

Early Action Activities Funding

- Can be funded through leveraged commitments
 - FWHA Share – \$264,525
 - CoFW Share – \$180,000
- Grantees can use up to \$150k of \$500k for Early Action Activities
 - HUD Share – \$105,000

Total EAA Funding - \$549,525



SEFW – TALL OAKS CHOICE NEIGHBORHOODS

SEFW CNI Proposed Early Action Activities

Activity selection was based on resident feedback and input.

1. Pedestrian Safety Measures
2. Placemaking Signage
3. Community Garden



EAA 1: Pedestrian Safety

- **Location**
 - Woodside Avenue
 - Sidewalk Extension (ADA-compliant)
 - East Tillman & Decatur
 - Pedestrian Crossing and Flashers
- **Anticipated Start Date**
 - October 2024



EAA 2: Community Garden

- **Location**
 - Onsite at Tall Oaks Apartments
- **Anticipated Start Date**
 - October 2024

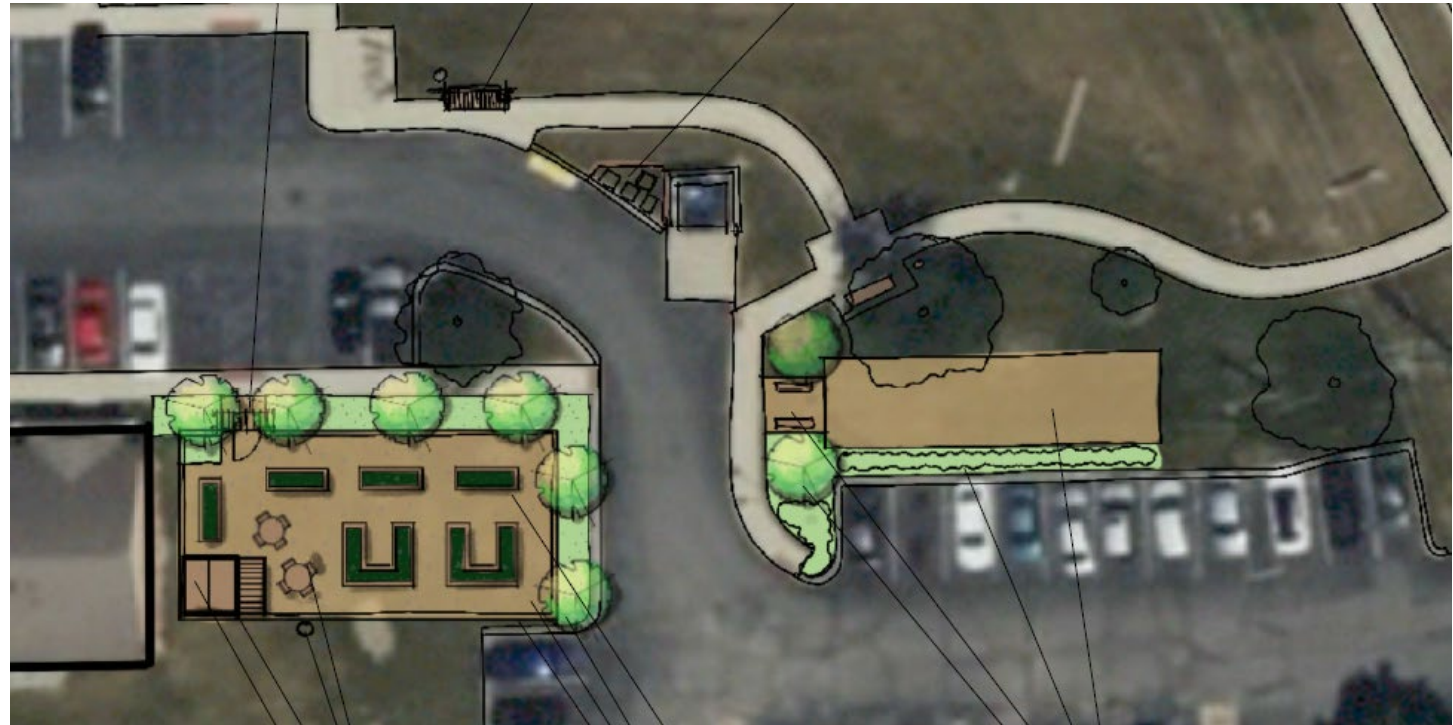

EAA 3: Placemaking Signage

Breakaway signage when entering the SEFW CNI neighborhood

- **Location**
 - East Tillman
 - Near Lafayette
- **Anticipated Start Date**
 - October 2024

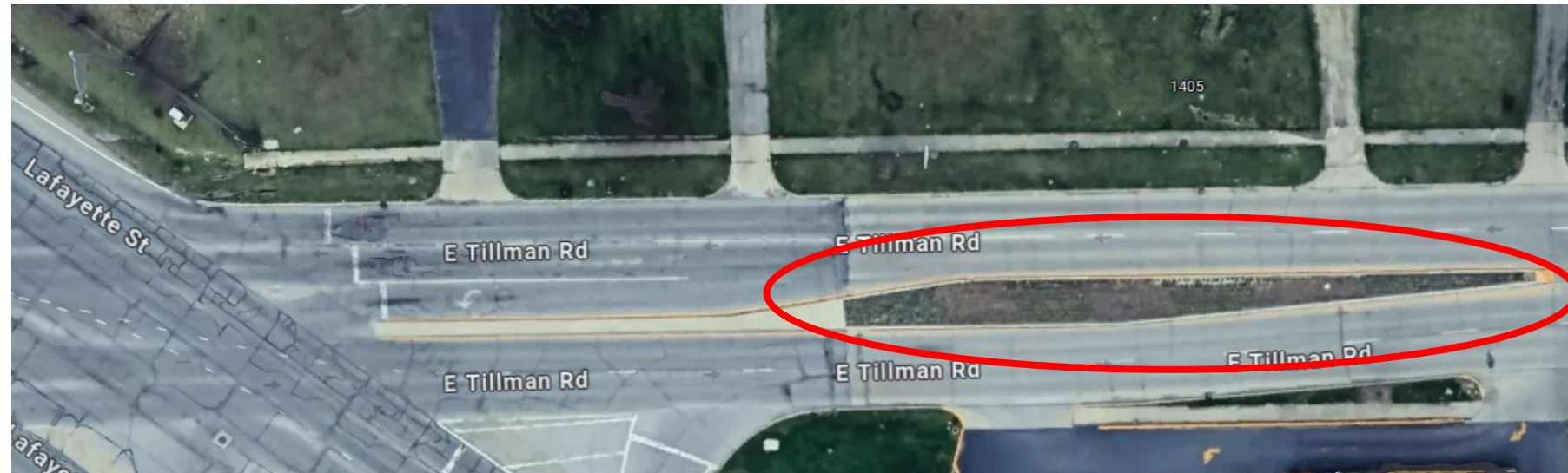



SEFW CNI
Redevelopment

SEFW – TALL OAKS CHOICE NEIGHBORHOODS

Data

(Community Survey)

What type of housing is missing in the SEFW CNI Neighborhood?

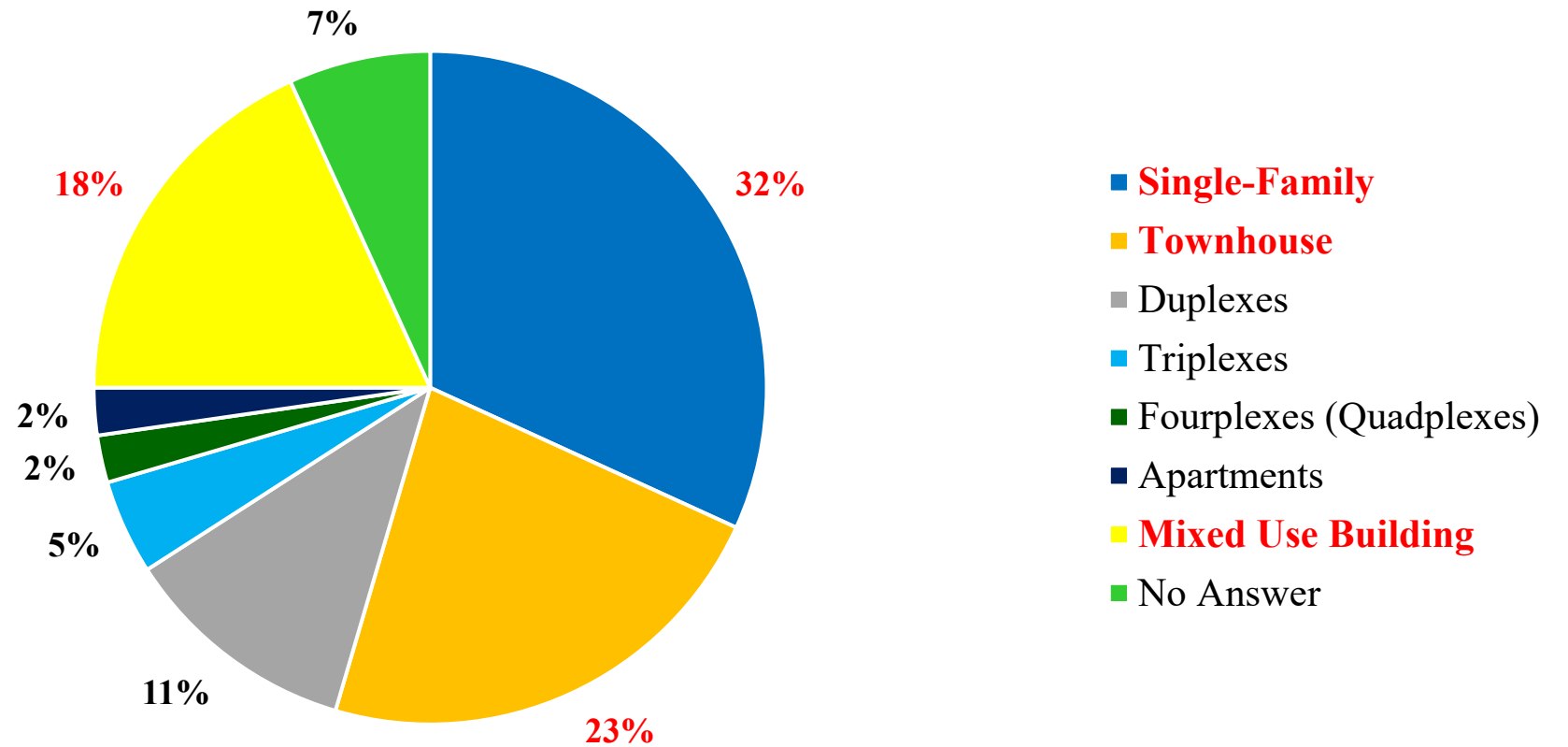

SEFW – TALL OAKS CHOICE NEIGHBORHOODS

Data (Community Survey)

What amenities do you want to see in the SFEW CNI Neighborhood?

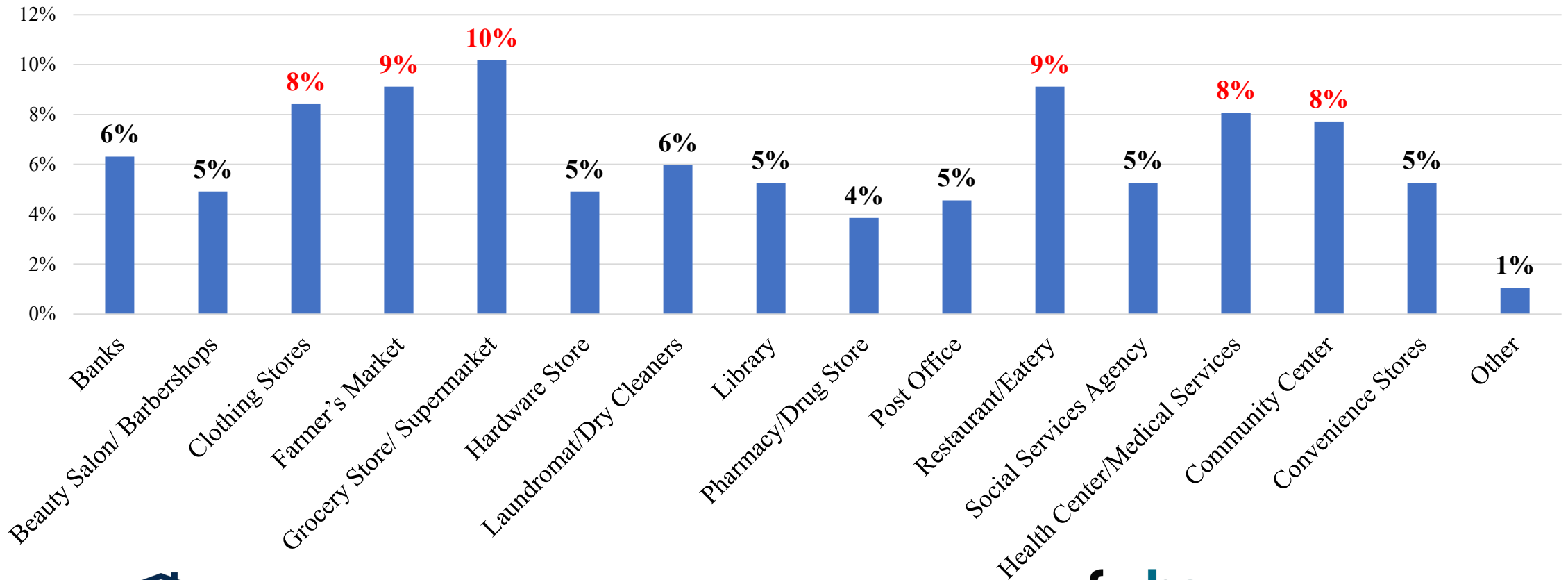



SEFW – TALL OAKS CHOICE NEIGHBORHOODS

Data (Community Survey)

To your knowledge, what services are missing in the SEFW CNI Neighborhood?

1. Mental Health Counseling/Assistance
2. Training to Help Start a New Business
3. Homeownership Counseling/Assistance



Next Steps



SEFW – TALL OAKS CHOICE NEIGHBORHOODS

Next Steps

- Transformation Plan Draft Submission – September 20th
- Grant Term Engagement
 - Committee Meetings
 - Partner Meetings
 - Community Meetings
- Transformation Plan Final Submission – December 21st
- Post Grant Term Engagement
 - Committee Meetings
 - Community Meetings



SEFW – TALL OAKS CHOICE NEIGHBORHOODS

Feedback QR

Scan the QR code to submit your feedback.

